

handles manufactured from shock-proof polypropylene

Griffe aus schlagfestem Polypropylen

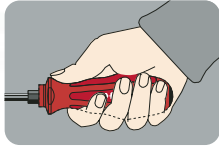

ergonomically refined design

ergonomisch ausgereiftes Design

steelcap

Stahl-Schlagkappe

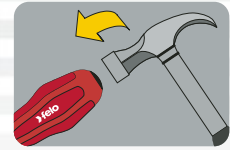

The strongest of series 200
Die Stärksten aus der Serie 200

Serie 206

steelcap / Stahl-Schlagkappe

full length blade / durchgehende Klinge

hexagon bolster / Schlüsselhilfe

hexagon blade / Sechskantklinge

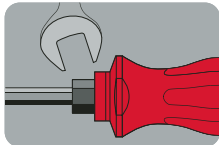

hexagon bolster

Schlüsselhilfe

anti-roll handle design

Griffkopf mit Abrollschutz

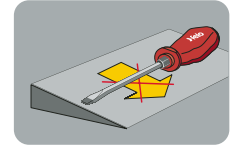

hexagon blades manufactured from chrome-molybdenum-vanadium steel

Sechskantklingen aus spezieller Chrom-Molybdän-Vanadium-Legierung



GS tested for safety

GS - geprüfte Sicherheit



EAN code on every product

EAN-Code auf jedem Werkzeug



superior torque which exceeds DIN and ISO requirements by up to 100%

Beste Leistungsdaten, bis zu 100% über DIN-Werten

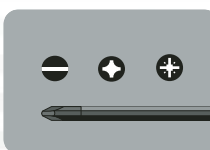

black tip for precision fit

Black-Tip für präzise Passung

full length blade

Durchgehende Klinge

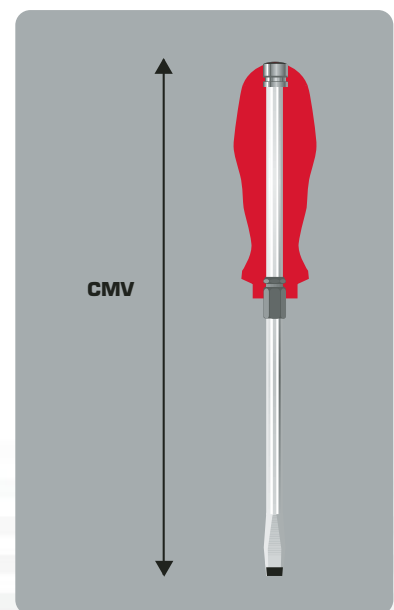

206

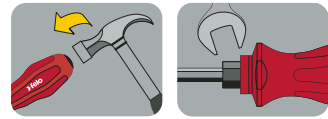

								Item No		EAN-Code
5,5 x 1,0	100	98	34	5,0	12		206 055 90	94	40 07157 31690 5	
6,5 x 1,2	125	98	34	6,35	12		206 065 90	120	40 07157 24036 1	
8,0 x 1,2	150	105	38	8,0	6		206 080 90	195	40 07157 30876 4	
10,0 x 1,6	175	105	38	8,0	6		206 100 90	204	40 07157 13166 9	
12,0 x 2,0	200	105	38	10,0	6		206 120 90	286	40 07157 31692 9	

216



								Item No		EAN-Code
PZ 2	100	98	34	6,35	12		216 203 90	115	40 07157 31694 3	
PZ 3	150	105	38	8,0	6		216 305 90	195	40 07157 31696 7	

226

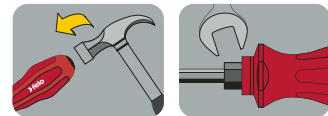

								Item No		EAN-Code
PH 2	100	98	34	6,35	12		226 203 90	115	40 07157 31698 1	
PH 3	150	105	38	8,0	6		226 305 90	194	40 07157 31700 1	

206

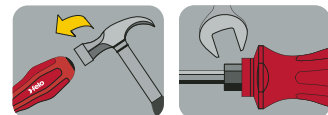

								Item No		EAN-Code
Set 5-pcs / Satz 5-tlg.								206 951 98	838	40 07157 31720 9
(3 x) 206:	5,5 x 100 / 6,5 x 125 / 8,0 x 150									
(2 x) 226:	PH 2 x 100 / PH 3 x 150									